

NOT
This drawing is not to be scaled. All dimensions to be checked on site. Responsibility for dimensions to be checked on site. All drawings to be made in conjunction with specifications where applicable.
© Mouchel

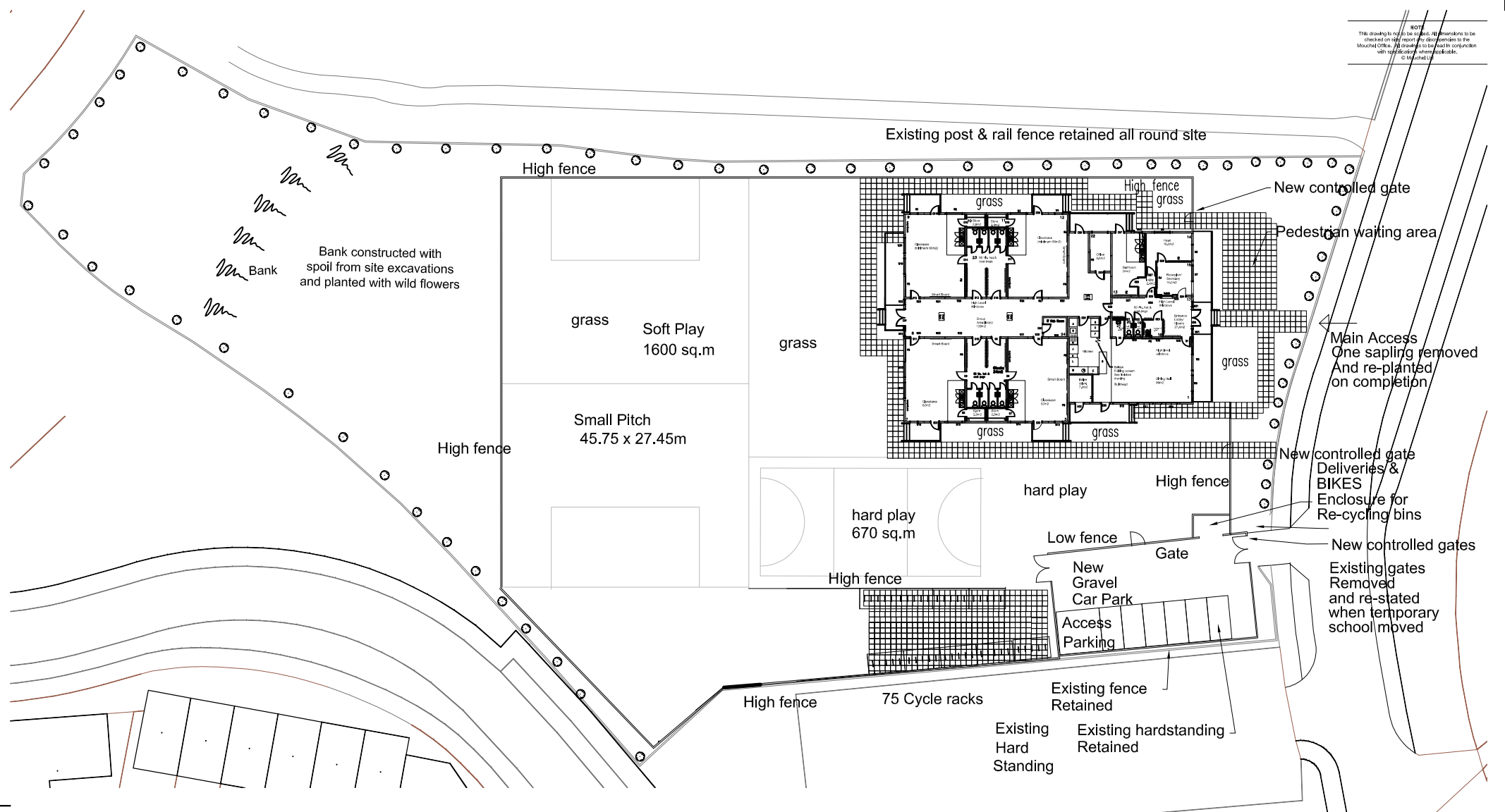

FENCING

GATES - SINGLE AND DOUBLE GATES:
As supplied by Heras UK Fencing Systems - HG1 gate range.
Height to match fencing 2000mm height.
Widths: 1200mm clear opening single gates; 4000mm clear opening double gates.
180 degree opening
Include: slip latch, drop bolts and drop bolt sockets (open and closed postfoms), adjustable hanging hlnges.
Finish: hot-dip galvanised and polyester powder coated dark green.

STEEL WELDMESH FENCING:
As supplied by Heras UK Fencing Systems - Chaperon range.
Height nom 2000mm
Pallas 200 style fencing
Posts: Heras "Hexafix" 60x40mm RHS, flat post caps
Finish: hot-dip galvanised and polyester powder coated dark green.
Flush edge at the top; barbed edge at bottom

BIKE SHELTER STANDS:
Manufacturer: Urban Engineering (tel: 01704-540405)
Shelter: UE/SAT/R10
Material/finish/colour: galvanised
Method of fixing: posts with base plate and fixed as recommended by manufacturer
Stands: UE/R8 - 50mm diameter tube galvanised with base plate and fixed as recommended by manufacturer
Shelter and stands to be fixed to an in-situ concrete base
Excavate an area of 0.25m deep x length and width of shelter plu 500mm (i.e. 250mm extended at ends and sides)
Lay geotextile membrane as Terram 1000 edges lapped 300mm
Lay and compact 125mm type 1 MOT stone
Lay grade A252 steel reinforcing mesh
Lay separation membrane: polyethylene sheet 125 micrometre thick, edges lapped 300mm
Pour 125mm grade C35 concrete
Tamped finish

WILD FLORA MEADOW AREAS
Mixture: Traditional Meadow Mix
Supplier and reference: Landlife Wildflowers Ltd (tel: 0151 7371819)
Rate of application: 1 g/m² or as recommended.

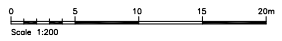

1st Floor, Millers, 15000, House
 2, Millers, 15000, House
 Cambridge
 CB3 0YR
 www.mouchel.com
 Tel: 01223442701
 Fax: 01223442701

1st Floor, Millers, 15000, House
 2, Millers, 15000, House
 Cambridge
 CB3 0YR
 www.mouchel.com
 Tel: 01223442701
 Fax: 01223442701

Cambridge Temporary School
 Temporary Accommodation
 Site Plan PHASE 1
 CAMBRIDGESHIRE COUNTY COUNCIL
 PLANNING
 Date: 09/08/2018
 Time: 12:00
 Job #: 739254
 Appr Date: 09/08/2018
 Des #: 1003